

# CEILING

## B-500 / 52

B-500/52 is a self suspended ceiling of sandwich construction and designed for easy and rapid installation with no connecting profiles.

No additional (loose) insulation required to maintain fire class.

Self suspended up to 3000 mm.

### Weight

All weights are based on system weight, including all profiles.

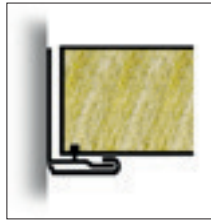
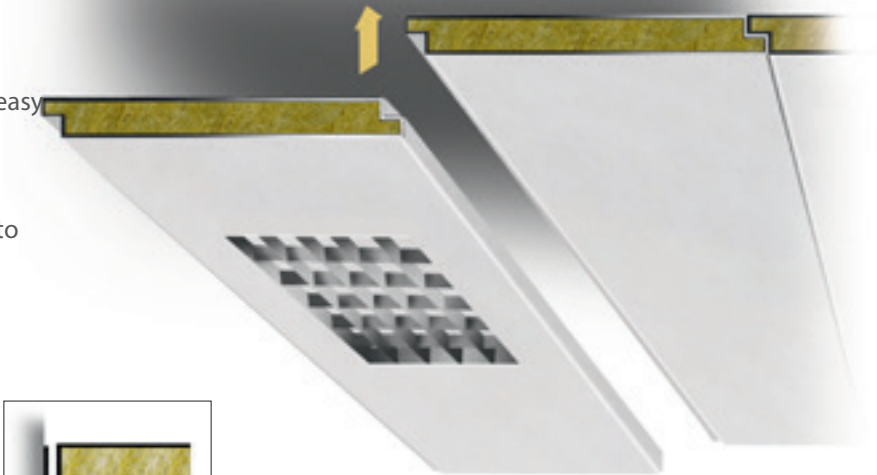

Clip-on profile to conceal rivets upon request.

Approved with light fittings. The ceiling has been shock tested. More information on request.

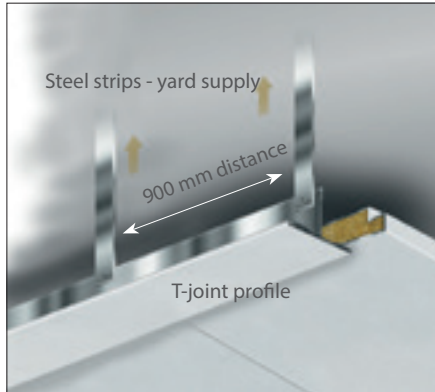
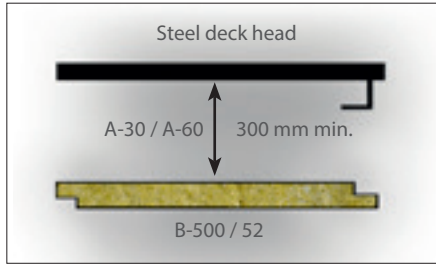

For rooms exceeding 3000 mm (also B-15).

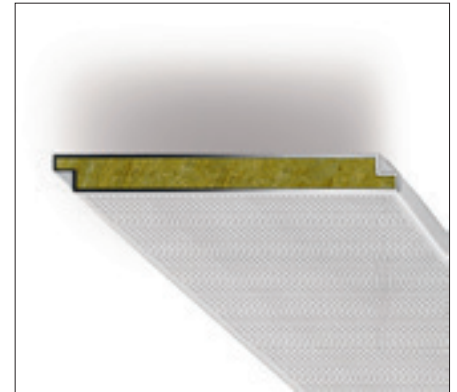

Approved B-15 with perforated surface.

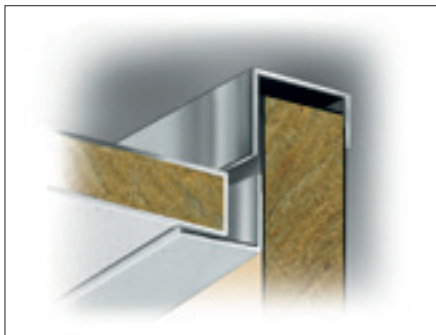

Start / stop element.

Description	B-500 / 52	B-500 / 52
Fire class	B-15 / A-30	A-60
Panel length	up to 3000 mm	up to 2400 mm
Standard module width	500 mm	500 mm
Special module width	100 - 700 mm	100 - 700 mm
Thickness	52 mm	52 mm
Weight	19.2 kg/m <sup>2</sup>	21.7 kg/m <sup>2</sup>
Sound reduction	R <sub>W</sub> =50 dB*	R <sub>W</sub> =50 dB*
Thermal isolation	U=0.64 W/m <sup>2</sup> K	U=0.64 W/m <sup>2</sup> K
Application	Self suspended ceiling	

\*Measured together with NORAC panel system.