

WALLS - INTERNAL LIGHT WEIGHT OMEGA

Early developments in composite firewalls by BD Systems utilised the “Omega” type joining profile. This series of panels is always popular where space saving and flexibility of installation are important considerations.

Significant loads can be secured to the walls when fixing directly into the “Omega” joints. Available as a standard or fully modular system.

Details

Non-load bearing lightweight A Class wall lining and partition panels for the offshore industry.

All weights shown are for the fully installed system and include all profiles.

Optional extras include – Conduit raceways (2 - 20 x 30), penetration kits and reinforcement posts and plates.

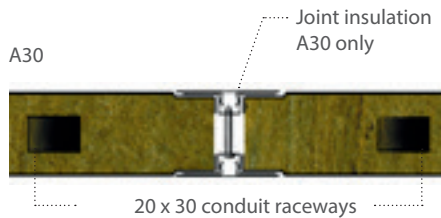
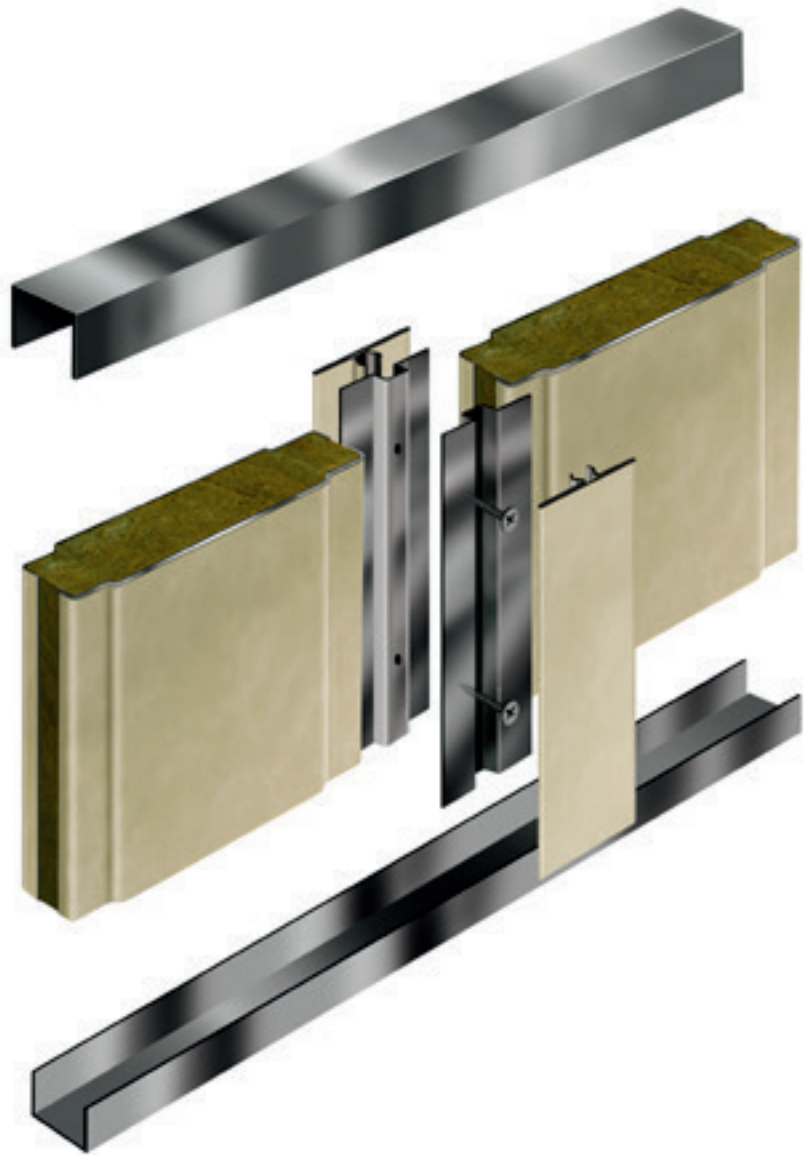

Description	FO - 25	FO - 50
Fire class	Non combustible	A0 - A30 / 1 hour
Standard width	600 nominal	600 nominal
Panel height	up to 3000 mm	up to 4500 mm
Thickness	27 mm	52 mm
Weight	16.6 kg/m ²	22.03 kg/m ²
Sound reduction	R _w =26 dB	R _w =32 dB
Thermal isolation	U=1.12 W/m ² K	U=0.61 W/m ² K
Application	Lining	Partition*

*Available with light weight insulation core

